

Schedule E

Map of interests granted under the *Minerals Act (NT)*, the *Petroleum Act (NT)* and the *Energy Pipelines Act (NT)*

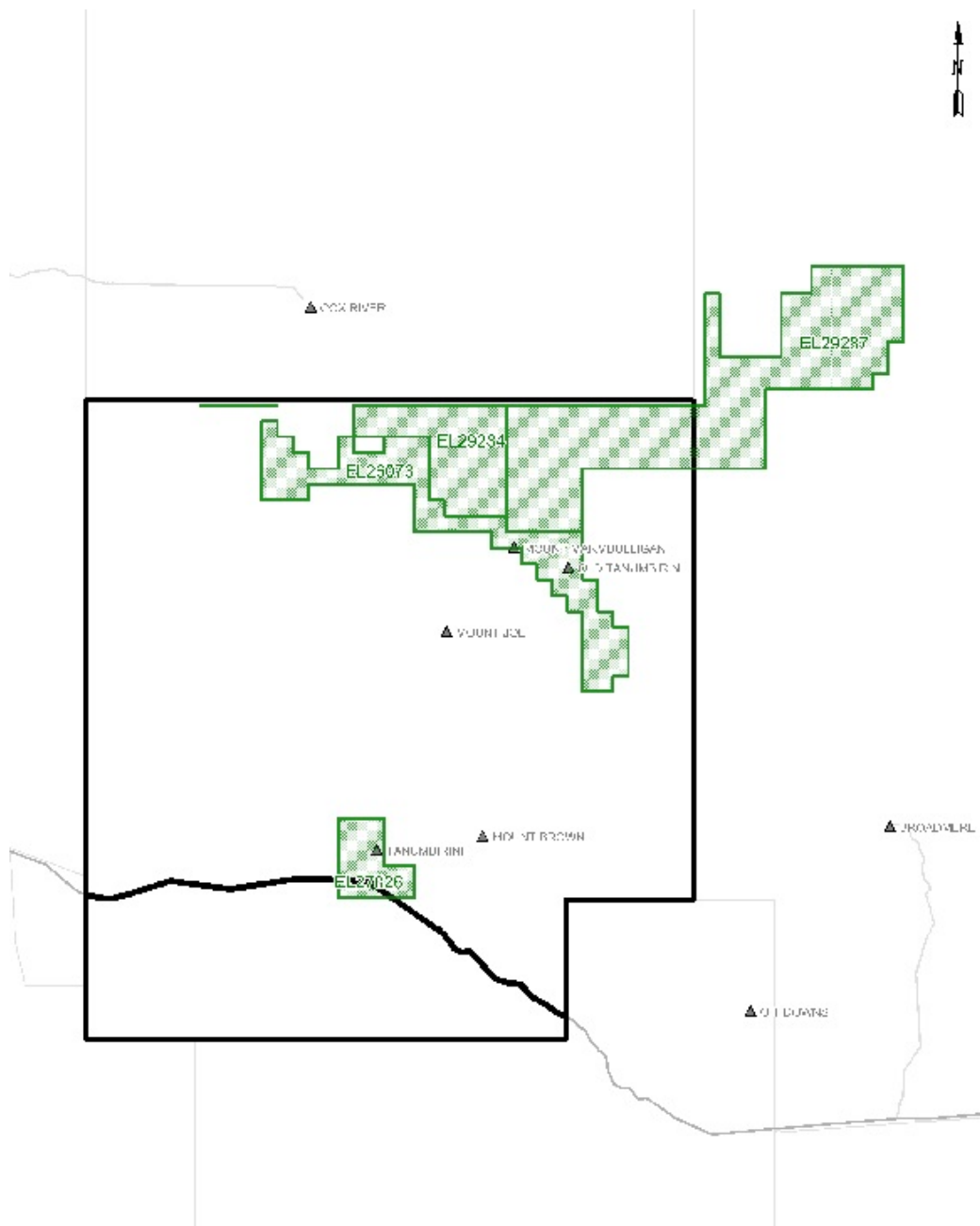





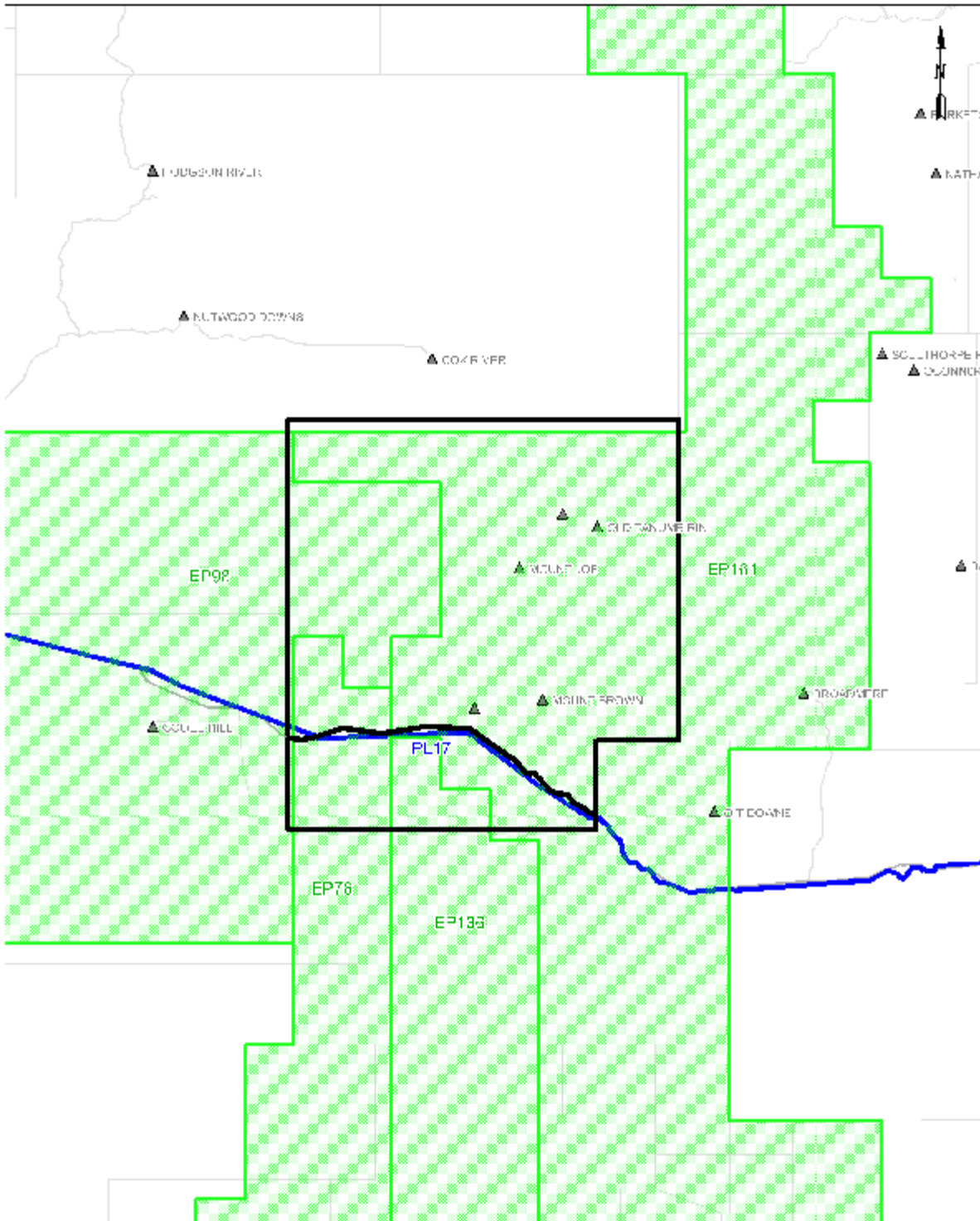

LEGEND			NTD33/2012 TANUMBIRIMI CURRENT EXPLORATION AND MINING TENURE	
NTD33/2012 TANUMBIRIMI	Granted Exploration Licences		Contourline	Road
		Locality		

Scale: 1:50,000
 Date: 31/10/2013
 Author: [Name]
 Title: [Title]

NTD33/2012 TANUMBIRIMI is a map generated from data collected on the map sheet(s) shown and is provided as a guide only. It is not a legal document. The Northern Territory Government does not warrant the accuracy of the information shown. For more information, please contact the Northern Territory Government.



LEGEND		 NTD33/2012 TANUMBIRINI CURRENT PETROLEUM AND GEOTHERMAL TENURE  Northern Territory Government <small>Map Date: 2013 Prepared By: [unclear] Tel: 61 8 894 6100</small>
 NTD33/2012 TANUMBIRINI	 Granted Exploration Permit	
 Granted Onshore Pipeline License	 Locality	 Road

Note: This map is for information purposes only and does not constitute an offer of any financial product or service. The Northern Territory Government does not warrant the accuracy of the information shown on this map. Users should be aware that information may be updated without notice and is subject to change.